



ADJUSTABLE PRESSURE SWITCH - K4 SERIES



Execution with electric connection
normally closed



Execution with electric connection
normally open

Technical features:

Body: 24 mm hexagonal in tropicalized carbon steel

Assembly: in every position

Maximum dimension (L =width max, H =height max):

- NC execution: L 26mm x H 55mm

- NA execution: L 26mm x H 45mm

Working temperature: from - 20°C to + 80°C

Switching frequency: 200 cycles/min

Switching accuracy: $\pm 5\%$ of the pressure settled to 20°C

Operating point: adjustable through an external screw

Fixed hysteresis value:

- membrane execution $\sim 6\%$ of the settled value

- piston execution $\sim 10\%$ of the settled value

Weight: 0,06 Kg

Mechanical life: 10^6 cycles at 70 bar (1000 psi) at 20°C

Electric Features:

- Maximum load: 2 Ampère at 48 Volt AC

1 Ampère at 48 Volt DC (see dedicated page)

- Electric protection according to DIN 40050: IP54 with P1 rubber cup protection

Warranty: see dedicated page

Spare parts: see dedicated page

Also available:

- K4X with fluid connection port made in Aisi 316 stainless steel

- K4L body in brass

- Seals in Viton, EPDM, PTFE

CE II 3 G/D EEx e T6

HOW TO ORDER

K4												/					P1	
Switching pressure range	Execution	p max	Type of electric contact	Type of Electric Connection	Hydraulic Connection						Body Material	Seal Type	Preset value	Condition	Protection Cap			
	Bar	Bar			0	1	2	3	4	5	6			Bar				
R	0,2>2.5	Membrane	25	A NA	F Fast-on 6.3 mm	1/8" BSP	1/4" BSP	1/8" BSPT	M10x1	1/8" NPT	1/4" NPT	1/4" BSPT	X AIS1316L L OTTONE If omitted means zinc plated	V VITON T PTFE E EPDM if omitted means NBR	D means down pressure setting U means up pressure setting	Accessory on request essential to protect the instrument from dirt and moisture		
S	1>12	Membrane	25			1/8" BSP	1/4" BSP	1/8" BSPT	M10x1	1/8" NPT	1/4" NPT	1/4" BSPT						
SP	1>12	Piston	300			1/8" BSP	1/4" BSP	1/8" BSPT	M10x1	1/8" NPT	1/4" NPT	1/4" BSPT						
T	5>50	Membrane	200			1/8" BSP	1/4" BSP	1/8" BSPT	M10x1	1/8" NPT	1/4" NPT	1/4" BSPT						
TP	5>50	Piston	300			1/8" BSP	1/4" BSP	1/8" BSPT	M10x1	1/8" NPT	1/4" NPT	1/4" BSPT						
V	10>100	Piston	300			1/8" BSP	1/4" BSP	1/8" BSPT	M10x1	1/8" NPT	1/4" NPT	1/4" BSPT						
Z	20>200	Piston	300			1/8" BSP	1/4" BSP	1/8" BSPT	M10x1	1/8" NPT	1/4" NPT	1/4" BSPT						
Y	50>400	Piston	600	C NC	O Screw connection	1/8" BSP	1/4" BSP	1/8" BSPT	M10x1	1/8" NPT	1/4" NPT	1/4" BSPT						

OY HYDRO-MATERIAL AB

Ruohosuontie 3, 02580 Siuntio

Puh. (09) 849 3300, Fax: (09) 8493 3022

E-mail: sales@hydro-material.fi Web: www.hydro-material.fi

oy hydro-material ab



ADJUSTABLE PRESSURE SWITCH - F4 SERIES



Execution with electric connection P2



Execution with electric connection M2



Execution with electric connection M3

Technical features:

Body: 24 mm hexagonal in tropicalized carbon steel

Assembly: in every position

Maximum dimension (L =width max, H =height max):

- P2 execution: L 26mm x H 50mm
- M2 execution: L 39mm x H 75mm
- M3 execution: L 48mm x H 78mm

Working temperature: from - 25°C to + 85°C

Switching frequency: 90 cycles/min

Switching accuracy: $\pm 4\%$ of the pressure settled to 20°C

Operating point: adjustable through an internal screw

Fixed hysteresis value:

- membrane execution $\sim 10\%$ of the settled value
- piston execution $\sim 15\%$ of the settled value

Weight: 0,05 Kg

Mechanical life: 10^6 cycles at 70 bar (1000 psi) at 20°C

Electric Features:

- Maximum load: 0.5 Ampère at 250 Volt AC (see dedicated page)
- Exchange contacts NA and NC
- Electric connection according to DIN 43650 for M2 and M3
- Electric protection according to DIN 40050:
 - IP65 for M2/M3 execution
 - IP54 for P2 execution

Warranty: see dedicated page

Spare parts: see dedicated page

Also available:

- F4X with fluid connection port made in Aisi 316 stainless steel
- K4L body in brass
- Seals in Viton, EPDM, PTFE
- **WF4:** vacuum switch with adjustable field from 0.15 to 0.75 bar

CE Ex II 3 G/D EEx eT6

HOW TO ORDER

F4 /															
Switching pressure range		Execution	P max	Body Material	Hydraulic Connection						Seal Type	Preset value	Condition	Type of Electric Connection	
	Bar		Bar		0	1	2	3	4	5	6		Bar		
R	0,2>2.5	Membrane	25	X AISI316L	1/8"BSP	1/4"BSP	1/8"BSPT	M10x1	1/8"NPT	1/4"NPT	1/4"BSPT	V VITON	Indicate the value if needed	D means down pressure setting U means up pressure setting	P2 Connection with screw M2 connector 16x16 M3 connector 30x30
S	1>12	Membrane	25		1/8"BSP	1/4"BSP	1/8"BSPT	M10x1	1/8"NPT	1/4"NPT	1/4"BSPT				
T	5>50	Piston	200	L BRASS	1/8"BSP	1/4"BSP	1/8"BSPT	///	1/8"NPT	1/4"NPT	1/4"BSPT	T PTFE			
V	10>100	Piston	300	If omitted means body in zinc plated	1/8"BSP	1/4"BSP	1/8"BSPT	///	1/8"NPT	1/4"NPT	1/4"BSPT	E EPDM			
Z	20>200	Piston	300		1/8"BSP	1/4"BSP	1/8"BSPT	///	1/8"NPT	1/4"NPT	1/4"BSPT	if omitted means NBR			
Y	50>400	Piston	600		1/8"BSP	1/4"BSP	1/8"BSPT	///	1/8"NPT	1/4"NPT	1/4"BSPT				

OY HYDRO-MATERIAL AB

Ruohosuontie 3, 02580 Siuntio

Puh. (09) 849 3300, Fax: (09) 8493 3022

E-mail: sales@hydro-material.fi Web: www.hydro-material.fi

oy hydro-material ab



ADJUSTABLE PRESSURE SWITCH - FS4 SERIES

Technical features:



Execution with electric connection M2



Execution with electric connection M3

Body: Ø 40 mm circular in tropicalized carbon steel

Assembly: through a 27 mm screw in every position

Maximum dimension (L =width max, H =height max):

- M2 execution: L 45mm x H 78 mm

- M3 execution: L 55mm x H 78 mm

Working temperature: from - 20°C to + 80°C

Switching frequency: 60 cycles/min

Switching accuracy: ± 4% of the pressure settled to 20°C

Operating point: adjustable through an internal screw

Fixed hysteresis value: ~ 12% of the settled value

Weight: 0,18 Kg

Mechanical life: 10⁶ cycles at 10 bar and 20°C

Electric Features:

- Maximum load: 0.5 Ampère at 250 Volt AC

0.15 Ampère at 110 Volt DC (see dedicated page)

- Exchange contacts NA and NC

- Electric connection according to DIN 43650

- Electric protection according to DIN 40050: IP65

Warranty: see dedicated page

Spare parts: see dedicated page

Also available:

- FS4X with fluid connection port made in Aisi 316 stainless steel

- Seals in Viton, EPDM, PTFE

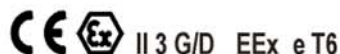

HOW TO ORDER

FS4.									
Type	Switching pressure range	Execution	P max	Hydraulic connection	Body material	Seal Type	Preset value	Condition	Type of Electric Connection
	Bar		Bar	Only			Bar		
FS40	0.1 > 1	Membrane	10	1/4"BSP	X AISI316L If omitted means zinc plated	V VITON	Indicate the value if needed	D means down pressure setting U means up pressure setting	M2 connector 16x16 M3 connector 30x30
FS41	0.3 > 3	Membrane	10	1/4"BSP		T PTFE			
FS42	0.5 > 5	Membrane	10	1/4"BSP		E EPDM			
FS43	1 > 10	Membrane	20	1/4"BSP		if omitted means NBR			

OY HYDRO-MATERIAL AB

Ruohosuontie 3, 02580 Siuntio

Puh. (09) 849 3300, Fax: (09) 8493 3022

E-mail: sales@hydro-material.fi Web: www.hydro-material.fi

oy hydro-material ab



ADJUSTABLE PRESSURE SWITCH - K3 – K3S SERIES



K3

Execution for high pressures



K3S

Execution for low pressures

Technical features K3

Body: : 27 mm hexagonal in tropicalized carbon steel

Assembly: in every position

Maximum dimensions:

L 57mm x H 70 mm

Switching accuracy:

± 4% of the pressure settled to 20°C

Fixed hysteresis value:

- membrane execution ~ 10%

- piston execution ~ 15%

Weight: 0,09 Kg

Technical features K3S

Body: 40x40mm square in anodised aluminium

Assembly: in every position

Maximum dimensions:

L 65mm x H 75 mm

Switching accuracy:

± 3% of the pressure settled to 20°C

Fixed hysteresis value:

~ 7% of the settled value

Weight: 0,1 Kg

Both common characteristics

Working temperature: from - 20°C to + 80°C

Switching frequency: 120 cycles/min

Operating point: adjustable through an internal screw

Electric connection type: 16x16 connector

Mechanical life: 10⁶ cycles at 70 bar (1000 psi) at 20°C

Electric features:

- Maximum load: 5 Ampère at 250 Volt AC

0.25 Ampère a 125 Volt DC (see dedicated page)

- Exchange contacts NA and NC

- Electric contact according to DIN 43650

- Electric protection according to DIN40050: IP65

Warranty: see dedicated page

Spare parts: see dedicated page

Also available:

- K3X , K3SX with fluid connection port made in Aisi 316 stainless steel

- Seals in Viton, EPDM, PTFE

- Microswitches with gold plated contacts

CE Ex II 3 G/D EEx e T6

HOW TO ORDER

K3..

Type	Switching pressure range	Execution	P max	Hydraulic Connection	Body Material	Seal Type	Microswitches Type	Preset value	Condition
	Bar		Bar					Bar	
K3S1	0.05 > 0.5	Membrane	10	1/4" BSP female	X AISI316L	V VITON	G Gold plated contacts	Indicate the value if needed	D means down pressure setting
K3S2	0.1 > 1	Membrane	10						
K3S3	0.5 > 5	Membrane	15						
K3S4	1 > 10	Membrane	15						
K31	1 > 10	Membrane	25	1/4" BSP male	if omitted means standard execution	T PTFE	if omitted means standard contacts	Indicate the value if needed	U means up pressure setting
K33	5 > 50	Membrane	200						
K33P	5 > 50	Piston	300						
K35	10 > 100	Membrane	200						
K35P	10 > 100	Piston	300						
K37	30 > 250	Piston	300			if omitted means NBR			

OY HYDRO-MATERIAL AB

Ruohosuontie 3, 02580 Siuntio

Puh. (09) 849 3300, Fax: (09) 8493 3022

E-mail: sales@hydro-material.fi Web: www.hydro-material.fi

oy hydro-material ab



ADJUSTABLE PRESSURE SWITCH - F3 - F3S SERIES



F3_/P2

Execution for high pressures



F3_/M3



F3S_/P2

Execution for low pressures



F3S_/M3

Technical Features F3

Body: 27 mm hexagonal in tropicalized carbon steel

Assembly: in every position

Maximum dimensions:

- P2: L 30mm x H 65mm

- M3: L 48mm x H 78mm

Switching accuracy:

± 4% of the pressure settled to 20°C

Fixed hysteresis value:

- membrane execution ~ 10%

- piston execution ~ 15%

Weight: 0,08 Kg

Technical Features F3S

Body: 40x40mm square in anodized aluminium

Assembly: in every position

Maximum dimensions:

- P2: L 55mm x H 72mm

- M3: L 55mm x H 85mm

Switching accuracy:

± 3% of the pressure settled to 20°C

Fixed hysteresis value:

~ 7% of the value settled

Weight: 0,1Kg

Both common characteristics

Working temperature: from - 20°C to + 80°C

Operating point: adjustable through an internal screw

Switching frequency: 90 cycles/min

Mechanical life: 10⁶ cycles at 70 bar (1000 psi) at 20°C

Electric features:

- Maximum load: 0.5 Ampère at 250 Volt AC
0.15 Ampère at 110 Volt DC

- Exchange contacts NA and NC

- Electric contact according to DIN 43650

- Electric protection according to DIN40050: IP65

Warranty: see dedicated page

Spare parts: see dedicated page

Also available:

- F3X, F3SX with fluid connection port made in Aisi 316 stainless steel

- Seals in Viton, EPDM, PTFE

- Microswitches with gold plated contacts

CE II 3 G/D EEx e T6

HOW TO ORDER

F3.. / ..										
Type	Switching pressure range	Execution	P max	Hydraulic Connection	Body Material	Seal Type	Microswitches Type	Preset value	Condition	Type of Electric Connection
	Bar		Bar					Bar		
F3S1	0.05 > 0.5	Membrane	10	1/4" BSP female	X AISI316L	V VITON	G Gold plated contacts	Indicate the value if needed	D means down pressure setting	P2 fast-on 6.3 mm
F3S2	0.1 > 1	Membrane	10			T PTFE				
F3S3	0.5 > 5	Membrane	15			E EPDM				
F3S4	1 > 10	Membrane	15			if omitted means standard execution				
F30	0.2 > 2.5	Membrane	10	1/4" BSP male	if omitted means standard execution	if omitted means NBR	if omitted means standard contacts	if omitted means standard contacts	U means up pressure setting	M3 Connector 30x30
F31	1 > 10	Membrane	25							
F33	5 > 50	Piston	300							
F35	10 > 100	Piston	300							
F37	30 > 250	Piston	300							
F39	100 > 400	Piston	600							

OY HYDRO-MATERIAL AB

Ruohosuontie 3, 02580 Siuntio

Puh. (09) 849 3300, Fax: (09) 8493 3022

E-mail: sales@hydro-material.fi Web: www.hydro-material.fi

oy hydro-material ab



ADJUSTABLE PRESURE SWITCH - KR6 SERIES

Technical features:



Body: 30x30 mm square in nickel-plated brass

Assembly: in every position

Maximum dimension (L = width max, H = height max):

L 69mm x H 52 mm

Working temperature: from - 20°C to + 80°C

Switching frequency: 90 cycles/min

Switching accuracy: $\pm 4\%$ of the pressure settled to 20°C

Operating point: adjustable through an internal screw protected by a cap

Fixed hysteresis value:

- membrane execution $\sim 10\%$ of the settled value

- piston execution $\sim 14\%$ of the settled value

Weight: 0,18 Kg

Electric connection type: 30x30 connector

Mechanical life: 10^6 cycles at 70 bar 20°C

Electric Features:

- Maximum load: 0.5 Ampère at 250 Volt AC

0.15 Ampère at 110 Volt DC (see dedicated page)

- Exchange contacts NA and NC

- Electric connection according to DIN 43650

- Electric protection according to DIN 40050: IP65

Warranty: see dedicated page

Spare parts: see dedicated page

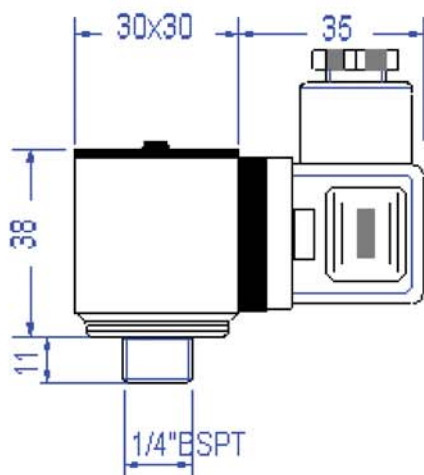

Also available:

- Seals in Viton, EPDM, PTFE

- Microswitches with gold plated contacts (instead of silver-plated as in the standard execution)



HOW TO ORDER

KR6.

/

Type	Switching pressure range	Execution	P max	Hydraulic Connection	Seal Type	Microswitches Type	Preset value	Condition	
	Bar		Bar	Only			Bar		
KR60	0.2 > 2	Membrane	25	1/4" BSPT male	V VITON	G Gold plated contacts	Indicate the value if needed	D means down pressure setting	
KR61	1 > 15	Membrane	25		T PTFE				
KR63	4 > 40	Piston	200		E EPDM	If omitted means standard contacts			U means up pressure setting
KR64	15 > 150	Piston	300						
KR65	25 > 250	Piston	300		If omitted means NBR				

OY HYDRO-MATERIAL AB

Ruohosuontie 3, 02580 Siuntio

Puh. (09) 849 3300, Fax: (09) 8493 3022

E-mail: sales@hydro-material.fi Web: www.hydro-material.fi

oy hydro-material ab



ADJUSTABLE PRESSURE SWITCH - K7 SERIES

Technical features:



K7 Standard



K7 + K7RID
(see adaptors page)

Body: 36 mm hexagonal in tropicalized carbon steel

Assembly: in every position

Maximum dimension (L =width max, H =height max):

L 74mm x H 84mm

Cap protection : in nylon charged with fiber glass

Working temperature: from - 20°C to + 80°C

Switching frequency: 120 cycles/min

Switching accuracy: $\pm 3\%$ of the pressure settled to 20°C

Operating point: adjustable through an internal screw protected by a cap

Fixed hysteresis value: $\sim 13\%$ of the settled value

Weight: 0,2 Kg

Mechanical life: 10^6 cycles at 70 bar (1000 psi) at 20°C

Electric Features:

- Maximum load: 5 Ampère at 250 Volt AC
0.25 Ampère a 125 Volt DC (see dedicated page)
- Exchange contacts NA and NC
- Electric connection according to DIN 43650
- Electric protection according to DIN 40050: IP65

Warranty: see dedicated page

Spare parts: see dedicated page

Also available:

- K7X with fluid connection port in AISI 316 stainless steel
- Seals in Viton, EPDM, PTFE
- Micro switches with gold plated contacts (instead of silver-plated as in the standard execution)
- Adaptor type K7RID for flange fixing (see adaptors page)
- Electric connector with light signal of insertion

CE II 3 G/D EEx e T6

HOW TO ORDER

K7.										
Type	Switching pressure range	Execution	P max	Hydraulic Connection	Body Material	Seal Type	Microswitches Type	Preset value	Condition	Type of Electric Connection
	Bar		Bar	Only				Bar		
K71	1 > 12	Membrane	25	1/4" BSP male	X AISI316L	V VITON	G Gold plated contacts if omitted means standard contacts	Indicate the value if needed	D means down pressure setting	M4 Electric connector with light signal of insertion
K73	5 > 50	Piston	300		If omitted means tropicalized carbon steel	T PTFE			U means up pressure setting	If omitted means standard connector
K75	15 > 150	Piston	350			E EPDM				
K77	30 > 300	Piston	400			If omitted means NBR				

OY HYDRO-MATERIAL AB

Ruohosuontie 3, 02580 Siuntio

Puh. (09) 849 3300, Fax: (09) 8493 3022

E-mail: sales@hydro-material.fi Web: www.hydro-material.fi

oy hydro-material ab



ADJUSTABLE PRESSURE SWITCH - K9 SERIES



K9 Standard



K9 + K7RID
(see adaptors page)

Technical features:

Body: 32 mm hexagonal in tropicalized carbon steel

Metal ring: Ø 40 mm in anodised aluminium

Assembly: in every position

Maximum dimension (L =width max, H =height max):
L 54mm x H 128mm

Working temperature: from - 20°C to + 80°C

Switching frequency: 120 cycles/min

Switching accuracy: ± 2% of the pressure settled to 20°C

Operating point: adjustable through an external metal ring

Fixed hysteresis value: ~ 12% of the settled value

Weight: 0,4 Kg

Mechanical life: 10⁶ cycles at 70 bar (1000 psi) at 20°C

Electric Features:

- Maximum load: 5 Ampère at 250 Volt AC
0.25 Ampère at 125 Volt DC (see dedicated page)

- Exchange contacts NA and NC

- Electric connection according to DIN 43650

- Electric protection according to DIN 40050: IP65

Warranty: see dedicated page

Spare parts: see dedicated page

Also available:

- Seals in Viton

- Micro switches with gold plated contacts (instead of silver-plated as in the standard execution)

- Adaptor type K7RID for flange fixing (see adaptors page)

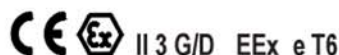

II 3 G/D EEx e T6

HOW TO ORDER

K9.								
Type	Switching pressure range	Execution	P max	Seal Type	Hydraulic Connection	Microswitches Type	Preset value	Condition
	Bar		Bar		Only		Bar	
K93	2 > 40	Piston	200	V VITON If omitted means NBR	1/4" BSP male	G Gold plated contacts if omitted means standard contacts	Indicate the value if needed	D means down pressure setting U means up pressure setting
K94	5 > 100	Piston	300					
K95	20 > 200	Piston	400					
K97	30 > 300	Piston	600					
K99	40 > 400	Piston	600					

OY HYDRO-MATERIAL AB

Ruohosuontie 3, 02580 Siuntio

Puh (09) 849 3300, Fax: (09) 8493 3022

E-mail: sales@hydro-material.fi Web: www.hydro-material.fi

oy hydro-material ab



ADJUSTABLE PRESSURE SWITCH - F5 SERIES

Technical features:

Body: 30x30 mm square in anodised aluminium

Assembly: in every position

Maximum dimension (L =width max, H =height max):

L 72mm x H 80mm

Working temperature: from - 20°C to + 80°C

Switching frequency: 120 cycles/min

Switching accuracy: $\pm 3\%$ of the pressure settled to 20°C

Operating point: adjustable through an internal screw protected by a safety cap

Fixed hysteresis value: $\sim 12\%$ of the settled value

Weight: 0,15 Kg

Mechanical life: 10^6 cycles at 70 bar at 20°C

Electric Features:

- Maximum load: 5 Ampère at 250 Volt AC

0.1 Ampère at 250 volt DC (see dedicated

page)

- Exchange contacts NA and NC

- Electric connection according to DIN 43650

- Electric protection according to DIN 40050: IP65

Warranty: see dedicated page

Spare parts: see dedicated page

Also available:

- Seals in Viton

- Micro switches with gold plated contacts (instead of silver-plated as in the standard execution)



F5



HOW TO ORDER

F5. /									
Type	Switching pressure range	Execution	P max	Hydraulic Connection	Seal Type	Microswitches Type	Preset value	Condition	
	Bar		Bar	Only			Bar		
F53	5 > 50	Piston	300	1/4" BSP female	V VITON	G Gold plated contacts	Indicate the value if needed	D means down pressure setting	
F55	15 > 150	Piston	350		If omitted means NBR	if omitted standard contacts		U means up pressure setting	
F57	30 > 300	Piston	400						

OY HYDRO-MATERIAL AB

Ruohosuontie 3, 02580 Siuntio

Puh. (09) 849 3300, Fax: (09) 8493 3022

E-mail: sales@hydro-material.fi Web: www.hydro-material.fi

oy hydro-material ab



ADJUSTABLE PRESSURE SWITCH - K5 SERIES



K5

Standard with screw
regulator



K5 P

Execution with
graduate knob



K51

Execution for low pressures

CE II 3 G/D EEx e T6

Technical Features :

Body : square 40x40mm in anodized aluminium

Assembly: in every position with 1/4" BSPF threaded port or Cetop flanged without needs adaptors

Maximum dimension (L =width max, H =height max):

- K51 standard execution: L 74mm x H 102mm

- K51 with knob execution: L 74mm x 120mm

- K5 standard execution: L 74mm x 80mm

- K5 with knob execution: L 74mm x 102mm

Working temperature: from - 20°C to + 80°C

Switching frequency: 120 cycles/min

Switching accuracy: ± 2% of the pressure settled to 20°C

Fixed hysteresis value: - piston execution ~ 12%
- membrane execution ~ 10%

Weight: 0,35 Kg

Mechanical life: 10⁶ cycles at 70 bar at 20°C

Electric Features:

- Maximum load: 5 Ampère at 250 Volt AC

0.25 Ampère at 125 Volt DC (see dedicated page)

- Exchange contact NA and NC

- Electric connection according to DIN 43650

- Electric protection according to DIN 40050: IP65

Warranty: see dedicated page

Spare parts: see dedicated page

Also available : - Seal in Viton

- Microswitch with gold plated contact

- Cetop modular manifold type B6 and B10 for attachment to electrovalves Cetop 3 and 5 (see adapters page)

- Electric connector with light signal of insertion

- Only for low pressures K51X with fluid port connection in Stainless Steel

HOW TO ORDER

K5..											
Type	Switching pressure range	Execution	P max	Material connection	Hydraulic connection	Seal or membran type	Type of microswitch	Preset value in Bar	Condition	Type pf execution	Type of electric connection
	Bar		Bar	Only low pressure	Only			Bar			
K51.1	0.2 > 2	Membrane	12	X AISI316L If omitted means body in Anodized aluminium	1/4" BSP female or connection to a Cetop panel without any adaptors	V VITON T PTFE If omitted means NBR	G Gold plated contact If omitted Means standard contacts	Indicate the value if necessary	D means down pressure setting U means up pressure setting	P execution with adjustable graduate knob If omitted means standard version	M4 Connector With light signal of insertion If omitted means standard connector
K51.2	0.5 > 5	Membrane	12								
K51.3	1 > 10	Membrane	15								
K51.4	3 > 15	Membrane	20								
K53	2 > 40	Piston	200								
K54	5 > 100	Piston	300								
K55	20 > 200	Piston	400								
K57	30 > 300	Piston	500								
K59	40 > 400	Piston	600								

OY HYDRO-MATERIAL AB

Ruohosuontie 3, 02580 Siuntio

Puh. (09) 849 3300, Fax: (09) 8493 3022

E-mail: sales@hydro-material.fi Web: www.hydro-material.fi

oy hydro-material ab

Technical features B6 and B10:

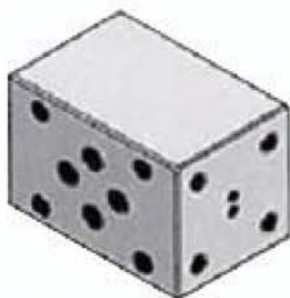

B6

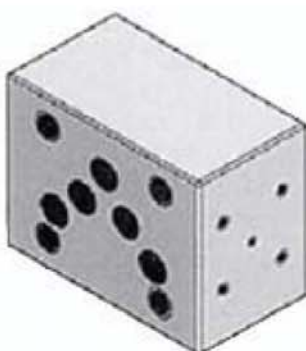

B10

Material: anodised aluminium

Maximum working pressure: 350 bar

Standard equipment:

- screws to fix the pressure switch
- dowel to close the pressure ports not in use
- O-ring for seal

Dimension:

- B6 70 x 45 x 44 mm
- B10 90 x 70 x 50 mm

Weight:

- B6 0.37 Kg
- B10 0.8 Kg

Technical features K7RID:

Material: tropicalized carbon steel

Maximum working pressure: 350 bar

Standard equipment:

- socket head screws M4x16
- O-ring for seal

Weight: 0.07 Kg

Manifolds for the modular connection to the electrovalves CETOP 3 or 5 for the K5 series

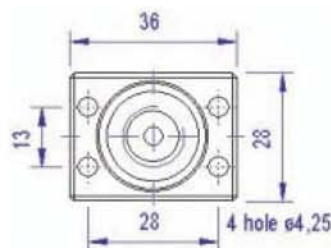

K7RID

Adaptor for K7 and K9

